

(BRQG - Oct 10, 17)
(T. Dietz)

THREAD CATCHER PINCUSHION

SUPPLIES:

- 2 coordinating Fat Quarters (FQs)
- 2 squares (5 1/2") tightly woven muslin/fabric [for sandbag]
- 2 buttons or 2 (pieces 1 1/4") both sides) strong velcro
- 18" strapping tape
- 3-4 cups Playsand & Funnel

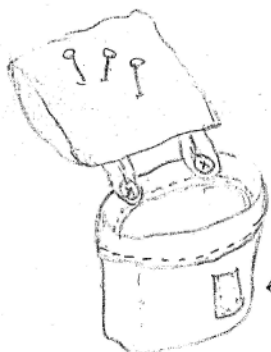

← optional pocket

Instructions:

TIP: Don't try to overfill sandbags. The sand will settle to make it look fuller when laying flat.

Sandbags: Sew both muslin squares together leaving opening for filling & turning. (If desired, reinforce seam.)

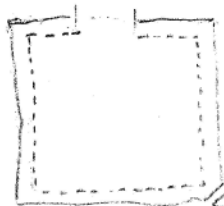

← 1/4" seam
← clip all four corners

Press, clip corners, turn right side out. Fill with sand to desired weight & whipstitch closed.

Threadcatcher Bag: 1) From Both FQs cut: 9 1/2" x 18" rectangles

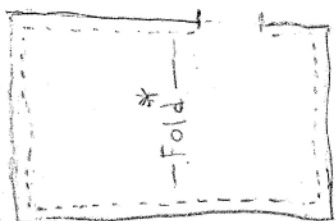

2) Layer right sides together; Use 1/4" seam: Sew all around leaving opening at top for turning.

3) Press, clip corners, turn right side out. (Opt.: Add pocket now)

4) *Fold in half right sides together! (side you want outside your bag)

5) Use 1/4" seam, sew side & bottom of bag.

6) Flatten corners of bag bottom. (1 1/2") Sew across at approx 1 1/2" from point

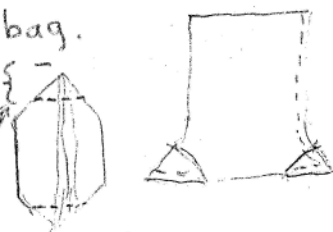

7.) Turn right sides out. Fold top edge over to outside bag approx 1".

Stitch down leaving an opening to insert strapping. Insert strapping & finish stitching being sure to catch opening from step 2. (You'll sew your buttons or velcro on inside of bag just above this stitching.)

Straps - For velcro: Cut 2" x 8" rectangle.

For buttons: Cut 1 1/4" - 1 1/2" x 9" rectangle.

- 1) Right sides out: iron in half. Press outer edges into fold (like a bias strip)
- 2) Top stitch. Cut in half to make 2 straps.

Pincushion: Cut 2 (6" squares) Sew together as you did for sandbag

*EXCEPT:  FRONT! 1) Place straps on front side of pincushion square before layering both right sides together AND 2) Leave back or one side OPEN to insert sandbag

After inserting sandbag, machine or hand-stitch to close.

Additional instructions from Tina

sew the 6" squares with their right sides together,

being sure to place their button loops inside the layers along the part of the pincushion they will have facing them (its front...they can refer to the small picture),

and to leave a side or back seam almost all the way open so the sand bag can be inserted easily.

Press and turn "right sides out".

After the sandbag is in place they can hand stitch or machine stitch the opening closed.